

SPECIFICATION

Range: **FLORIANOPOLIS**

Design: **Mario Trimarchi**

Codes: **18TRFG-N, 18TRFP-N**

Description: plant pots composed of: a supporting structure made of square-section steel tubulars measuring 20x20 mm for the base and the four vertical uprights, and 20x40 mm for the upper section; a removable tray made of black high-tech polymer with a glossy external finish, featuring a dynamic, asymmetrical rounded shape; a removable top that acts as a lid, made of sheet steel, with irregularly shaped perforations that follow the contour of the tray. The plant pots, available in two shapes, are modular and can be joined together exclusively along the 39 cm side using a pair of painted steel plates and special fasteners. The frame and top are finished with matt black epoxy powder coating.



18TRFG-N



18TRFP-N

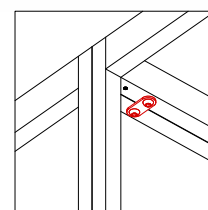
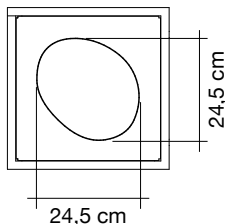
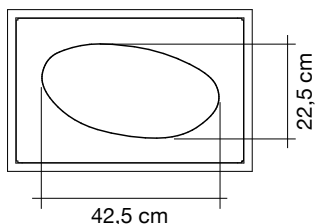
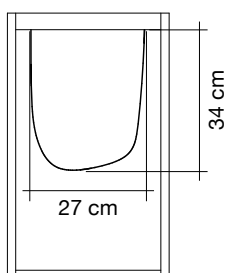
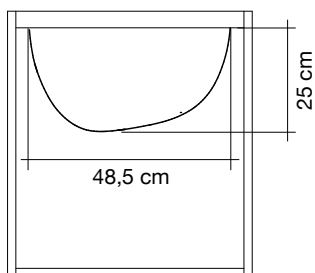
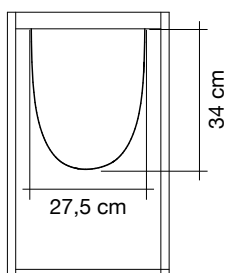
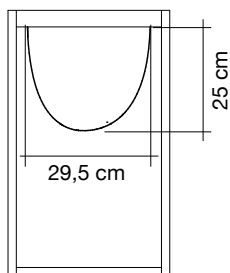

Linear joint plate

Deze informatie is afkomstig van de website van Zero-Z design.
Voor vragen, toelichting en meer informatie kunt u contact opnemen met:

Zero-Z design

Modem 20b

7741 MJ Coevorden

T +31 (0)30 2201297

E info@zero-z-design.nl

W www.zero-z-design.nl

www.akoestiekexpert.nl

